

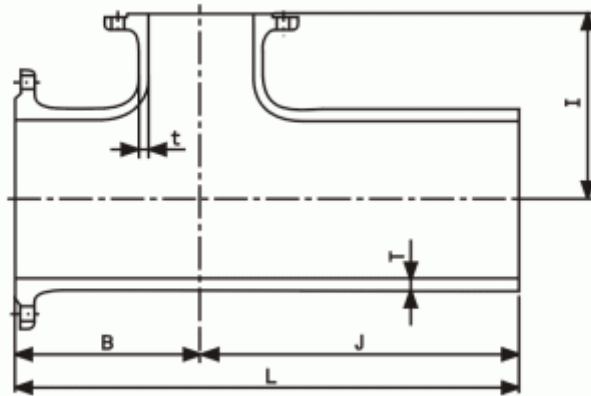

Double Flanged Tee



Unit: mm

Nominal size		Thickness		Dimensions				Weight (kg)			
Φ	d	T	t	B	I	J	L	7.5 K	10 K	16 K	20 K
75	75	8.5	8.5	160	140	480	640	19.3	16.3	17.8	18.4
100	75	8.5	8.5	180	160	530	710	24.7	21.4	23.4	24.0
100	100	8.5	8.5	180	160	530	710	25.9	22.3	24.8	25.5
150	75	9.0	8.5	190	190	600	790	37.0	34.9	37.8	39.2
150	100	9.0	8.5	190	190	600	790	38.2	35.8	39.1	40.7
150	150	9.0	9.0	190	190	600	790	40.9	39.7	43.9	46.3
200	100	11.0	10.0	200	230	560	760	54.3	51.2	55.6	57.2
200	150	11.0	11.0	250	250	630	880	64.4	62.5	67.7	70.2
200	200	11.0	11.0	250	250	630	880	67.7	65.1	71.4	74.0
250	100	12.0	10.0	230	250	600	830	76.4	73.8	80.8	84.3
250	150	12.0	11.0	230	250	600	830	79.3	77.9	85.8	90.1
250	250	12.0	12.0	280	260	670	950	96.2	94.6	106.2	112.4
300	100	12.5	10.0	240	280	600	840	94.2	89.6	99.1	102.9
300	150	12.5	11.0	240	280	600	840	97.1	93.7	104.1	108.7
300	200	12.5	11.0	330	300	700	1030	117.0	112.9	124.3	129.0
300	300	12.5	12.5	330	300	700	1030	127.0	121.4	138.0	144.8
350	250	14.0	12.0	360	340	750	1110	155.0	148.8	167.2	174.3
350	350	14.0	13.0	360	340	750	1110	166.0	192.8	180.4	188.4
400	300	14.0	12.5	410	390	780	1190	201.0	195.8	220.7	230.9
400	400	14.0	14.0	410	390	780	1190	214.0	209.2	242.4	256.0
450	300	15.0	12.5	440	420	820	1260	243.0	236.6	267.5	279.1
450	450	15.0	14.5	440	420	820	1260	266.0	258.8	304.0	320.4
500	300	15.0	12.5	480	460	850	1330	288.0	281.5	317.8	330.3
500	350	15.0	13.0	480	460	850	1330	294.0	284.9	325.5	338.6
500	500	15.0	15.0	480	460	850	1330	317.0	309.6	365.6	383.8
600	400	16.0	14.0	550	530	920	1470	403.0	400.7	453.3	471.2
600	500	16.0	15.0	550	530	920	1470	419.0	415.4	479.4	499.6
600	600	16.0	16.0	550	530	920	1470	434.0	434.2	506.2	528.4
700	400	17.0	14.0	620	600	980	1600	528.0	527.8	590.5	642.1
700	500	17.0	15.0	620	600	980	1600	543.0	541.5	615.6	669.5
700	600	17.0	16.0	620	600	980	1600	557.0	559.3	641.4	697.3
700	700	17.0	17.0	620	600	980	1600	577.0	581.4	673.6	763.2



SHIN NAN CASTING FACTORY CO., LTD. Unit: mm

Nominal size		Thickness		Dimensions				Weight (kg)			
D	d	T	t	B	I	J	L	7.5 K	10 K	16 K	20 K
800	500	18.0	15.0	690	670	1030	1720	692.0	689.9	782.2	872.3
800	600	18.0	16.0	690	670	1030	1720	705.0	706.7	807.0	899.1
800	700	18.0	17.0	690	670	1030	1720	724.0	727.8	838.2	964.0
800	800	18.0	18.0	690	670	1030	1720	751.0	754.2	882.8	1044.8
900	600	19.0	16.0	600	690	940	1540	749.0	744.1	855.8	966.9
900	700	19.0	17.0	770	750	1090	1860	907.0	904.2	1026.0	1170.8
900	800	19.0	18.0	770	750	1090	1860	933.0	929.6	1069.6	1250.6
900	900	19.0	19.0	770	750	1090	1860	966.0	956.0	1107.4	1307.4
1000	600	20.0	16.0	680	770	990	1670	930.0	929.1	1072.1	-
1000	800	20.0	18.0	840	820	1140	1980	1130.0	1130.6	1301.9	-
1000	1000	20.0	20.0	810	820	1140	1980	1190.0	1188.0	1402.0	-
1100	600	21.0	16.0	650	800	1000	1650	1050.0	1052.1	1203.1	-
1100	800	21.0	18.0	740	830	1050	1790	1170.0	1173.6	1352.9	-
1100	1100	21.0	21.0	910	890	1200	2110	1450.0	1454.0	1684.0	-
1200	600	22.0	17.0	680	860	1000	1680	1210.0	1222.1	1393.1	-
1200	900	22.0	19.0	810	910	1100	1910	1420.0	1427.0	1637.7	-
1200	1200	22.0	22.0	970	950	1250	2220	1730.0	1754.0	2024.0	-
1350	600	24.0	19.0	700	950	1000	1700	1510.0	1523.0	1734.1	-
1350	900	24.0	19.0	860	1000	1150	2010	1790.0	1798.0	2048.7	-
1350	*1350	24.0	24.0	1080	1050	1350	2430	2420.0	2446.0	2796.0	-
1500	600	26.0	21.0	730	1050	1000	1730	1830.0	1853.1	2101.1	-
1500	1000	26.0	21.0	920	1100	1200	2120	2250.0	2272.0	2591.0	-
1500	*1500	26.0	26.0	1180	1150	1400	2580	3030.0	3076.0	3500.0	-

Note: Tees marked with * on the column of D.N shall be reinforced with ribs.

SHIN NAN CASTING FACTORY CO., LTD.

SHIN NAN CASTING FACTORY CO., LTD.

SHIN NAN CASTING FACTORY CO., LTD.

SHIN NAN CASTING FACTORY CO., LTD.

SHIN NAN CASTING FACTORY CO., LTD.

SHIN NAN CASTING FACTORY CO., LTD.